

Ra12.5 / (Ra6.3 /)

DETAIL C
Scale 5:1

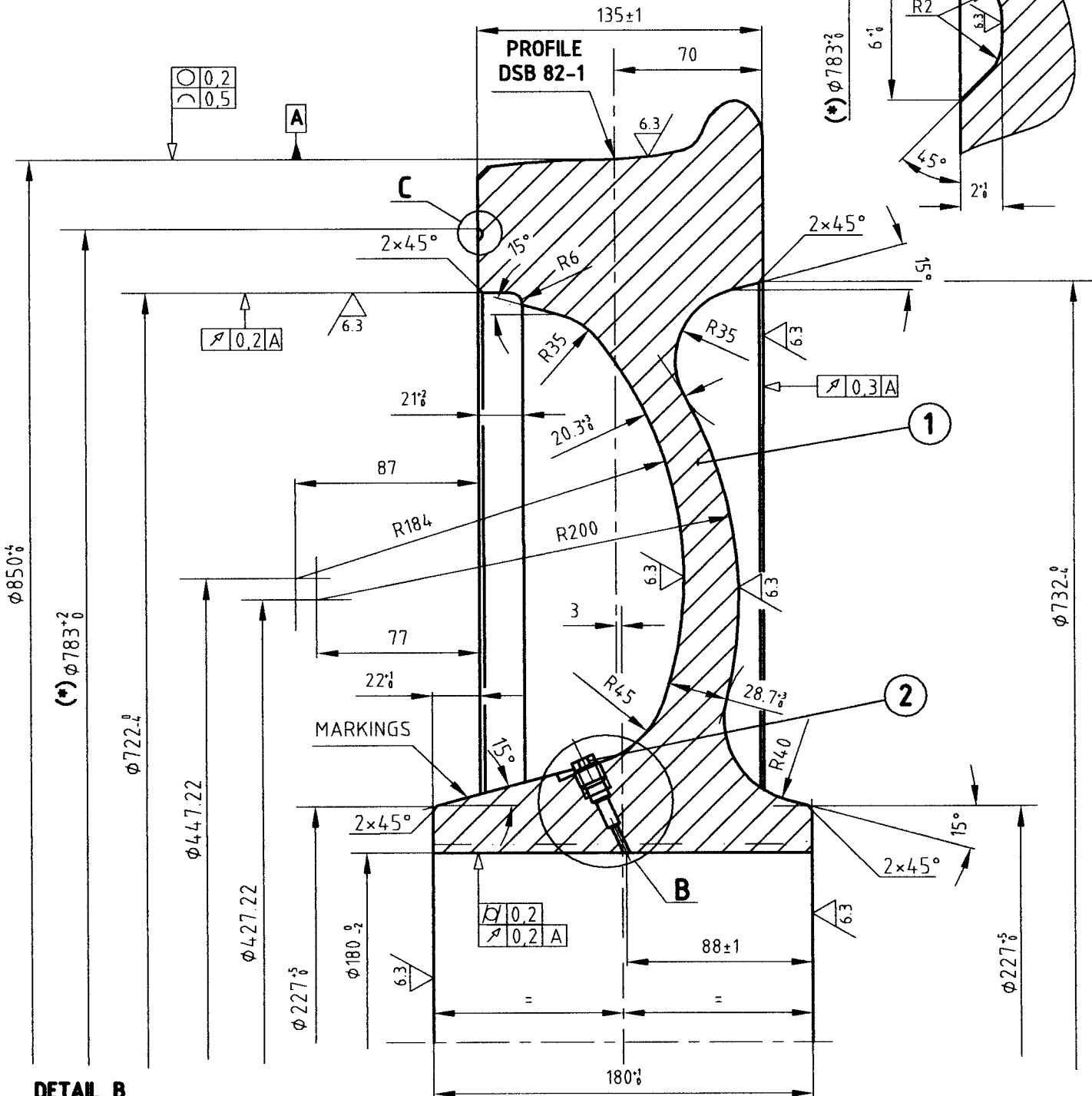

DETAIL B
Scale 1:1

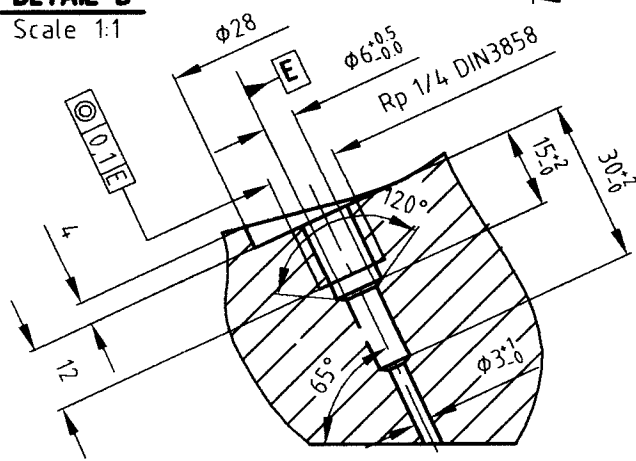

NOMINAL DIAMETER OF AXLE 187 mm

**Solid wheel statically balanced,
admissible residual imbalance: 75 gm**

(*) - Revision from 05.04.2006

1	HEXAGON HEAD PIPE PLUG DIN909 - R1/4- S1	2
1	ER8 (**)	1
Quant'	Size	Material
No		
ISRAEL RAILWAYS		ROLLING STOCK DIVISION
Name	Date	Drw' name
	14.10.04	SOLID WHEEL ϕ 850
	Drawn	(FOR IC-3/Sets No 11-24) (*)
	Verified	
Scale 1:2		Drw' No ME
		416.00.3(A)
		APPENDIX 2
Part of Technical Specification No M-04-48E		
(**) - Last revision from 26.11.2008		