

Ra12.5 / (Ra6.3)

○	0.2
⌒	0.5

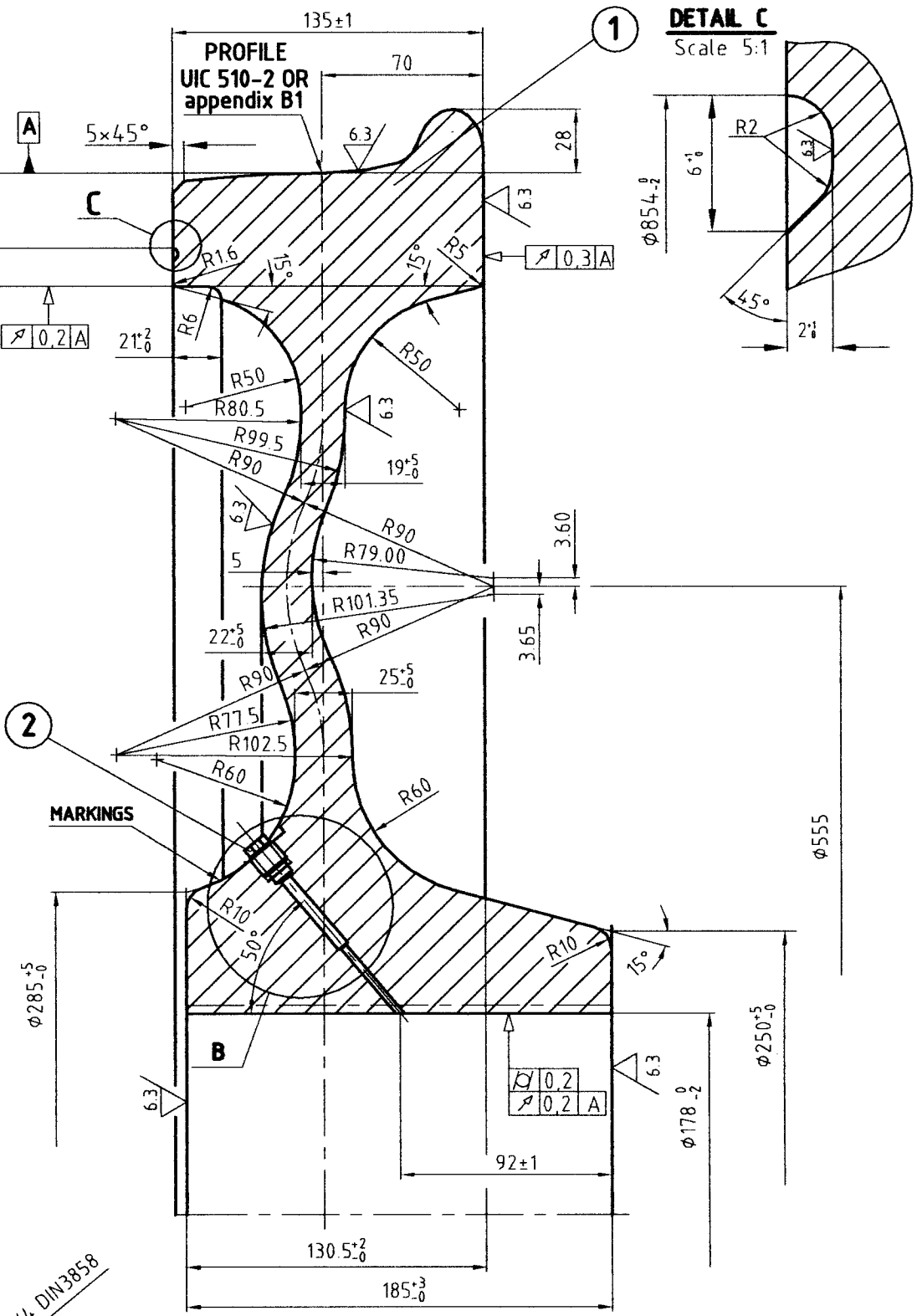

DETAIL C
Scale 5:1

DETAIL B
Scale 1:1

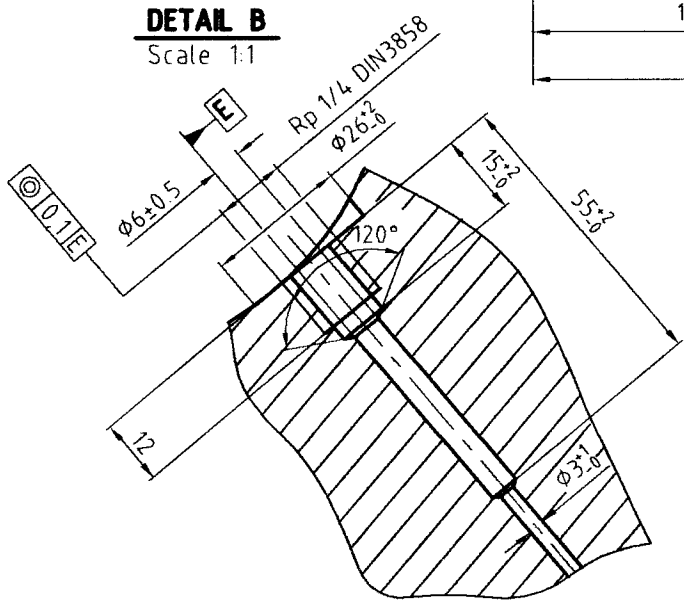

**Solid wheel statically balanced,
admissible residual imbalance: 125 gm**

**NOMINAL DIAMETER OF AXLE 185 mm
AXLE LOAD 20t**

1	HEXAGON HEAD PIPE PLUG DIN909 - R1/4- St	2	
1	ER7 (*)	1	
Quant'	Size	Material	No
ISRAEL RAILWAYS		ROLLING STOCK DIVISION	
Name	Date	Drw' name	Drw' No
	14.10.04	SOLID WHEEL ϕ 920	ME
	Drawn	(FOR OLD FREIGHT WAGONS)	355.00.3(B)
	Verified	Scale 1:2	APPENDIX B
Part of Technical Specification No M-04-48E			
(*) - Last revision from 26.11.2008			